

# LED Solar Street Light-C I 50W

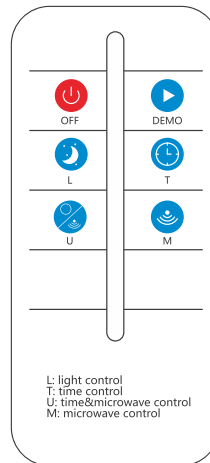

- No matter day or night, light "OFF"
- No matter day or night, light "NO" for 1 minute
- At night, 12hrs full power
- At night, 4 hrs full power+8hrs 25%
- At night, 4 hrs full power+8hrs motion sensor control
- At night, 12 hrs motion sensor control

## Features

1. All-in-one integrated design, easy to install
2. Die-cast aluminum alloy, anti-corrosion imitation marble painting surface
3. Solar pane 360 degrees adjustable, RGB flash light
4. Microwave radar sensor, MPPT controller, charging and overcharging protection
5. UVA(unmanned aerial vehicle) remote control, long distance detective
6. High-efficiency monocrystalline silicon solar panel, lithium battery
7. 4 light modes, RGB flash light, can be used as multi-function lighting

## Shenzhen ERS Technology

Factory Add: C209, Baohuasen International Center, Qianjin Second Road, Xixiang Town, Bao'an District, Shenzhen, China  
Warehouse Add: 57 Tarnard Dr, Braeside VIC 3195

Tel: 048 470 3010  
Email: info@erstech.com.au



**IPART**  
Independent Pricing and Regulatory Tribunal  
New South Wales



**Victorian Energy Upgrades**



**LM-80 TM 21 LM 79**  
**ISTMT LCP**



## APPLICATION

Widely used in branch roads, streets, and factory roads, parks, villages, mountainous areas and remote areas like, courtyards, schools, squares and other places that need outdoor lighting.



## STRUCTURE



## Shenzhen ERS Technology

Factory Add: C209, Baohuasen International Center, Qianjin Second Road, Xixiang Town, Bao'an District, Shenzhen, China  
Warehouse Add: 57 Tarnard Dr, Braeside VIC 3195

Tel: 048 470 3010

Email: [info@erstech.com.au](mailto:info@erstech.com.au)



IPART  
Independent Pricing and Regulatory Tribunal  
New South Wales



Victorian  
Energy  
Upgrades



LM-80 TM 21 LM 79  
ISTMT LCP



## SPECIFICATIONS

Item No.	ERS-SSC-50W
Lumen	5000lm
Color Temperature	3000K 4000K 5000K 6000K 7000K
Material	High-end Aluminum Alloy + Fire-rated PC
Battery	Lithium battery 11.1V (24-63AH)
Solar Panel	Monocrystalline Silicon 18V (50-160W)
LED	Bridgelux 3030
Waterproof IP Grade	IP 67
Discharge Time	Lighting 12 hours/day, support 10 rainy and cloudy days (motion sensor)
Charging Time	4-5hours (Bright sunshine)
Installation Diameter	Φ 60-65mm (Suggest)
Product Size	598*230*261mm
Product Weight	11-15kg
Working Temperature	-25℃ to + 65℃
Certificate	CE ROHS IP65
Warranty	5 years
Remote Control	yes
Color Rendering Index	Ra≥80

Inductive head	LED Indicator status	Function
	Red (blinking)	Charging
	Red (bright)	Full charge
	Blue (off)	Out of battery
	Green (bright)	Normal work

## Shenzhen ERS Technology

Factory Add: C209, Baohuasen International Center, Qianjin Second Road, Xixiang Town, Bao'an District, Shenzhen, China  
Warehouse Add: 57 Tarnard Dr, Braeside VIC 3195

Tel: 048 470 3010  
Email: info@erstech.com.au



Victorian  
Energy  
Upgrades



LM-80 TM 21 LM 79  
ISTMT LCP



## INTELLIGENT MICROWAVE INDUCTION

The second generation of integrated solar street lights equipped with the latest microwave induction technology. Solve the technical problem that traditional microwave induction is easily disturbed. Sensing distance up to 30 meters. Two to three times that of traditional infrared sensors, guarantee the effective lighting of street lamps, more environmental and energy saving.



## INSTALLATION INFORMATION

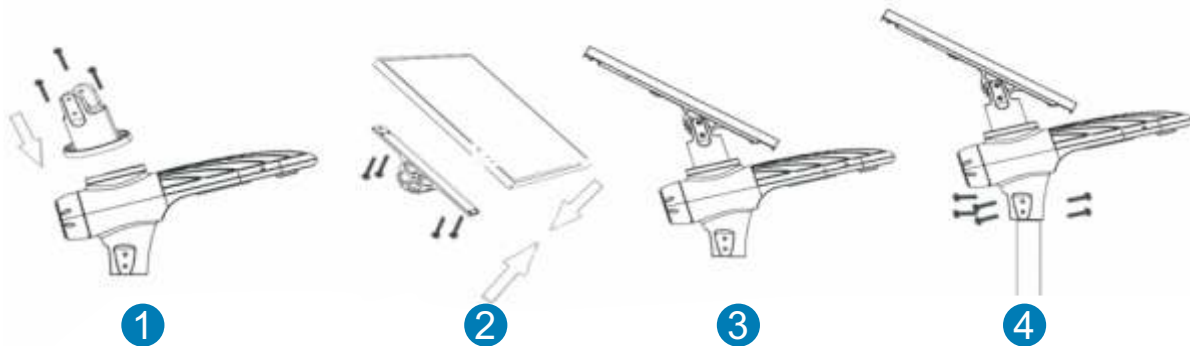

1. Determine the direction of the rotating fastener, tighten the screws;
2. Secure solar panels and brackets with screws;
3. Use 2 longer screws to adjust the angle fixed;
4. Mount the lamp into the pole and tighten the screw.

## DIMENSION (Unit:mm)

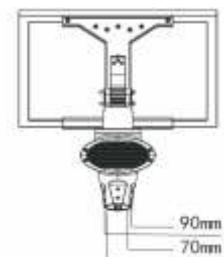
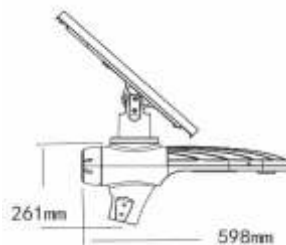
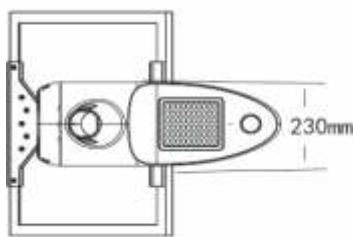

## Shenzhen ERS Technology

Factory Add: C209, Baohuasen International Center, Qianjin Second Road, Xixiang Town, Bao'an District, Shenzhen, China  
Warehouse Add: 57 Tarnard Dr, Braeside VIC 3195

Tel: 048 470 3010  
Email: info@erstech.com.au



IPART  
Independent Pricing and Regulatory Tribunal  
New South Wales



Victorian  
Energy  
Upgrades



LM-80 TM 21 LM 79  
ISTMT LCP

